

Installation instructions for Merika® floor drain

Merika no. 198

32 mm side connection

Opening the side connection of the floor drain

Before installing the drain Merika no. 198 in the floor, open the side connections if needed by hitting them with the purpose-built opening tool (Merika no. 1991), (image A).

Image A

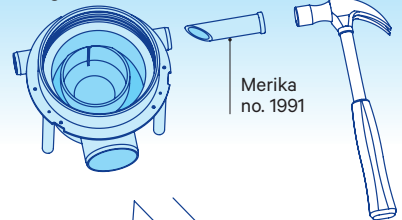

Installation in a wooden floor

- The floor drain is attached by its flange to the auxiliary beams as shown in image B. **The drain must not be supported from the bottom due to potential depression of the floor. The drain shall be installed horizontally.**
- Make a $\varnothing 170$ mm hole in the floor board for the drain.
- The floor board is attached with 5×40 mm wood screws to the drain flange (image C). **NOTE! The screws must not touch the pipes!**
- Fill the gap between the drain and the board with sealing mass.

Image B

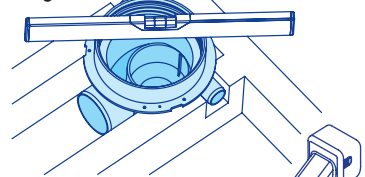

Installation in a concrete floor

- Check before the casting work that the drain is level.
- When casting the floor, note the slope reducing effect of the water insulation flange and materials by the drain, which is especially important when using minimum slopes (1:100).

Installing the foot of the floor drain:

- Use the floor drain foot (Merika no. 195), (image D) as a help when installing the drain to the correct height.
- The foot of the floor drain is cut to the correct height and the drain is attached to the foot with screws. (The screws and the screw bit belong to the installation package delivered with Merika 195).
- After this, the foot of the floor drain is attached to the floor with the screws. The drain should also be tied to the reinforcements.

Image C

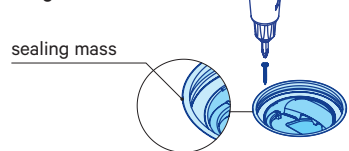
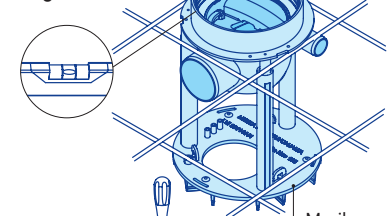

Image D



Installing the build up ring to the floor drain

- By removing the M-440 build up wedges (2 pcs) delivered with the drain one at a time, the height of the build up ring can be lowered in intervals of 10 mm, without sawing the build up ring (image E2 on the other side).
- In case height needs to be lowered even after this, the build-up ring can be cut by sawing it to the correct length and **straight**. The edge is bevelled.
- The build-up ring is lubricated and pushed to its place. The build up ring is attached with the supplied screws (3 pcs) to the flange of the drain.
- The screws are screwed to their places but **do not tighten them** (image E1).
- If the build up ring is installed to the drain before casting, it shall be attached to e.g. the reinforcements.
- The clamp ring removed from the drain and the (red) casting protection suit into the build up ring.

Image E1

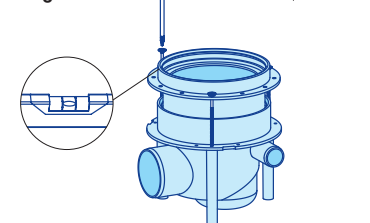

THE CASTING PROTECTION CAN NOT BE REMOVED UNTIL THE VINYL FLOORING OR BUILD UP RING ARE INSTALLED OR WHEN MAKING THE WATER INSULATION.

Installing vinyl flooring or water insulation flange

The clamp ring of the floor drain suits for 1,5–2 mm vinyl floorings.

- The drain and the sealing are cleaned carefully.
- Check that the sealing is intact and in its place.
- Install the vinyl flooring to its place and cut it carefully.
- The vinyl flooring can be expanded by heating.
- The clamp ring and the cover are placed to the top of the drain and pushed evenly to the place.
- Make sure that the clamp ring is in the bottom.
- The vinyl flooring is cut along the clamp ring and the cover is put to its place. Thanks to the flexible V lip seal the vinyl flooring joint is tight without glue. Use a water insulation flange for attaching water insulation masses in tile floors (Merika no. 458).

Installing the square cover to the drain or to a build up ring

- The square cover is attached by spreading the adhesive evenly on the drain or around the build up ring.
- After this, push the square cover to its place.
- In addition to these instructions the regulations of the Ministry of Environment *C2 National Building code of Finland/Humidity, regulations and guidelines 1998* must be followed.

Cleaning and maintenance of the drain

If the drain or the pipe needs cleaning, proceed in accordance of the image F.

- Pour warm water into the drain.
- Lift the inner part of the drain off by pulling the handle.
- Clean the drain and pipes.

After cleaning:

- In case the sealing in the inner part is damaged, you should replace it. The sealing in the inner part is lubricated (e.g. soap solution) before installing the inner part to the drain.
- The inner part is aligned to the correct position in the body and pushed to its place.

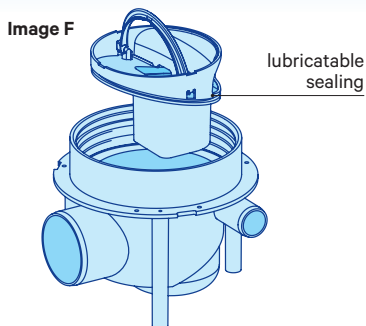
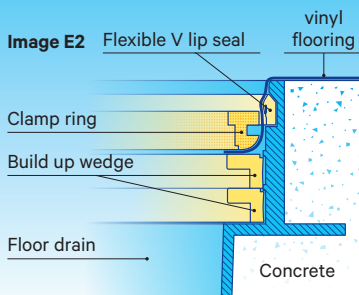

Use Merika build-up rings Merika no. 400, 401, 412, 413 and 414 for these floor drains.

Merika drains and build up rings are type approved. The approval requires that all products used belong to the Merika product series.



Supplies

- M-198** Floor drain, HVAC nr: 3311416
- M-400** Build up ring, HVAC nr: 3318112
- M-401** Build up ring, HVAC nr: 3318110
- M-412** Build up ring, HVAC nr: 3318117
- M-413** Build up ring, HVAC nr: 3318111
- M-414** Build up ring, HVAC nr: 3318155
- M-457** Water insulation flange, HVAC nr: 3319671
- M-458** Water insulation flange, HVAC nr: 3319673
- M-1991** Special opening tool, HVAC nr: 3311417
- M-195** Floor drain foot, HVAC nr: 3311414, RSK nr: 7133841

Spare parts

- M-199_05** Sealing of the water lock of the floor drain
- M-202_03** Floor drain lip sealing, new 160
- M-197** Waterlock for a horizontal drain*
- M-196** Back pressure part for the water lock of the floor drain*
- M-1971** Water lock with a back pressure part for a floor drain*
- M-441** Merika clamp ring 150 mm
- M-440** Merika build up wedge

*) from 06/2017 on

The installation shall follow the regulations of the National Building Code of Finland, D1 and C2.



Meriser Oy

Kauppatie 2, 29900 Merikarvia, Finland
Tel. +358 207 189 810
www.merika.fi, merika@meriser.fi

We follow the terms
of the Association
of Technical Traders.



OF QUALITY FOR
HVAC TECHNOLOGY